



SUPPLEMENTARY REGULATIONS

International Karting Distributors
In conjunction with Dubbo Kart Club

Present the

2015 ROTAX PRO TOUR NATIONAL SERIES - ROUND 2

To be held at

Dubbo Kart Club
Lincoln County Raceway – Newell Highway, Brocklehurst NSW

On

20th, 21st & 22nd March 2015



KARTING AUSTRALIA SUPPLEMENTARY REGULATIONS

Held under the International Sporting Code of the FIA, the General Standing Regulations and National Competition Rules of Karting Australia and the Series Sporting Regulations as approved by KA.

Permit Number: KARPT02/2015

Event Status: National Series Event

Promoter: International Karting Distributors

Organiser: Dubbo Kart Club

Organising Committee: Ian Black and Donald Stevens – International Karting Distributors, 02 4735 1344

Graham Reynolds – Dubbo Kart Club, 0490 101 894

Arthur Mortimer – Dubbo Kart Club, 0418 281 133

Date: 20th, 21st & 22nd March 2015

Location: Lincoln County Raceway – Newell Highway, Brocklehurst NSW

Officials of the Meeting:

CLERK OF THE COURSE:	Graeme Monds
ASSISTANT CLERK OF COURSE:	Ian Hobden, Stephen Cuskelly, Max Laybutt
CHIEF STEWARD:	Chris Robinson
STEWARDS:	Dawn Hull, Wayne Bradwell, Kim Freer
COMPETITOR RELATIONS OFFICER:	Marta Laybutt
RACE/COMPETITION SECRETARY OF THE MEETING:	Arthur Mortimer
CHIEF TIMING OFFICER:	John Martin – KA CM:S
CHIEF SCRUTINEER:	Ashley Woolner
SCRUTINEERS:	Paul Hull, Chris Riley
STATE TECHNICAL OFFICER:	Graeme Abbott
TECHNICAL OFFICERS:	Wayne Ogilvie, Tony Lawson, Benjamin Churchland
FUEL TESTER:	Benjamin Churchland
TYRE TESTER:	Tony Lawson
TYRE SCANNERS:	Dubbo Kart Club
SCALE MARSHAL:	Jeanette Monds
FLAG MARSHALS:	Howard Greatz and the DKC Flag Marshals Team
PIT/PADDOCK MARSHAL:	Darren Koenig
IN/OUT GRID ACCESS MARSHALS:	Bruce Walters and Doug Baker
STARTER:	Tim Mortimer
ASSISTANT STARTER:	Graham Reynolds
GRID MARSHALS:	Matthew Wray and Craig Tailby
LAP SCORERS:	Arthur Mortimer, Cheree Everingham, Rachael Wrigley.
NOISE CONTROL MARSHAL:	Doug Pearce
ANNOUNCER:	Liam Meegan
JUDGES OF FACT:	General Rules, Chapter 7, Rule 19
FIRST AID:	John Armstrong
TRACK SAFETY OFFICER:	Darren Koenig
TYRE DATA ENTRY:	Brinley Gread & Stephanie Sandrone
NATIONAL OFFICIALS COORDINATOR:	Mark Horsley
NATIONAL TECHNICAL COMMISSIONER:	Les Allen

Eligible Classes in accordance with the Competition Rules, Chapter 5, Rule 3 and the 2015 Rotax Pro Tour National Series Sporting Regulations.

	Total Entry Fee
Micro Max	\$190
Mini Max	\$190
Junior Max Trophy	\$190
Junior Max	\$230
Rotax 125 Light	\$230
Rotax 125 Heavy	\$230
DD2	\$230
DD2 Masters	\$230

Total Entry fee includes the KA driver levy and GST

Close of Entries: Sunday 15th March 2015 – A late entry fee of \$20 will be applicable after this date

ENTRIES WILL ONLY BE ACCEPTED ONLINE USING THE FOLLOWING METHOD:

KA ONLINE ENTRIES:

- a. Log on to your driver information via <http://www.karting.net.au/>
- b. Click on the licence and entries icon (top centre of the screen)
- c. Click on the “Enter a race meeting” icon
- d. Enter your log on details
- e. Under ‘My Details’ functions, choose ‘Pre Enter Race Meeting’
- f. Then choose NSW here and finally Dubbo Kart Club

POSTAL ENTRIES: Only entries received on the official KA entry form available at www.karting.net.au will be accepted.

Post Entry Form to – Dubbo Kart Club, PO Box 1592, Dubbo, NSW, 2830.

METHOD OF PAYMENT: Cheque / Money Order made out to – Dubbo Kart Club

EFT payments should be made to:

Dubbo Kart Club

BSB: 012-615

Acc No: 2124 17414

Reference: Full Name and KA Licence Number - single payments per driver

CONDITIONS OF ENTRY:

- Eligibility is limited to drivers who are holders of a current KA licence valid for the Class which they are entering.
- Refusal or acceptance of entries is in accordance with General Rules, Chapter 1, Rule 16.
- The Race Secretary reserves the right to allocate/change competition numbers in accordance with the Competition Rules, Chapter 1, Rule 11 k).
- The promoters reserve the right to abandon, postpone or cancel any event as in accordance with the Rules.
- Refund of Entry Fee will be in accordance with the Technical Rules, Chapter 4 Rule 5g)
- **LATE ENTRIES WILL BE ACCEPTED at the discretion of the Organiser**

MINIMUM ENTRIES (Competition Rules, Chapter 5 Rule 4 l):

If less than eight (8) genuine entries are received to constitute a Class by the listed close of entries then the Class will NOT be contested. All drivers whose entry is not accepted for any Class shall be notified as soon as possible and entry fee will be returned.

<u>FORMAT OF RACING:</u>	
Track Length:	1037 Metres
Track Density:	40 karts
Direction of Racing:	Anti-clockwise
Method of Racing	
Under-subscribed Classes:	<p>In accordance with Competition Rules, Chapter 6, Rule 2.</p> <ol style="list-style-type: none"> 1. One 8 minute timed Qualifying Session. Grid position for Qualifying will be based on the last of the two timed Practice Sessions for each Class on Friday for all Senior Classes and on Saturday for all Junior Classes. (Fastest to Grid 1 and so on) 2. Micro Max, Mini Max, Junior Max Trophy: Three (3) heats of 10 laps each Junior Max, Rotax 125 Light, Rotax 125 Heavy, DD2, DD2 Masters: Three (3) heats of 12 laps each 3. Micro Max, Mini Max, Junior Max Trophy: Pre-final of 15 laps Junior Max, Rotax 125 Light, Rotax 125 Heavy, DD2, DD2 Masters: Pre-final of 18 laps 4. Micro Max, Mini Max, Junior Max Trophy: Final of 18 laps 5. Junior Max, Rotax 125 Light, Rotax 125 Heavy, DD2, DD2 Masters: Final of 22 laps
Over-subscribed Classes:	<p>In accordance with Competition Rules, Chapter 6, Rule 6.</p> <ol style="list-style-type: none"> 1. One 8 minute Qualifying Session. Grid positions for Qualifying will be based on the last of the two timed Practice Sessions for each Class on Friday for all Senior Classes and on Saturday for all Junior Classes. Group 1 will be the slowest 50% of the fastest times with Grid 1 being occupied by the fastest driver of the group from the timed practice sessions, Grid 2 the second fastest and so on. 2. Micro Max, Mini Max, Junior Max Trophy: Three (3) heats of 8 laps each Junior Max, Rotax 125 Light, Rotax 125 Heavy, DD2, DD2 Masters: Three (3) heats of 10 laps each 3. Micro Max, Mini Max, Junior Max Trophy: One (1) Pre-final of 15 laps Junior Max, Rotax 125 Light, Rotax 125 Heavy, DD2, DD2 Masters: One (1) Pre-final of 18 laps The competitor with the lowest aggregated points from all the heats to Grid 1, next to Grid 2 and so on up the Grid 40. Drivers with equal points will be determined by the best qualifying time. 4. Micro Max, Mini Max, Junior Max Trophy: One (1) Final of 18 laps 5. Rotax 125 Light, Rotax 125 Heavy, DD2, DD2 Masters: One (1) Final of 22 laps

THE FINISHING ORDER IN THE FINAL DETERMINES THE WINNING POSITIONS IN EACH SERIES CLASS AND/OR DIVISION

MEETING TIMETABLE:

The Race Track at Lincoln County Raceway will be CLOSED from Monday 16th March to and including Thursday 19th March 2015.

Thursday, 19th March 2015

9.00am	Gates Open
9.00am – 4.00pm	Pit Allocation and Set-up <u>ONLY</u> - Contact Race Secretary Office/Control Tower: Bert Wrigley - 0427 871 286
12.00pm- 4.00pm	Confirmation of Senior entries

Friday, 20th March 2015

6.00am	Gates Open
6.00am	Pit Allocation- Contact Race Secretary Office/Control Tower: Bert Wrigley - 0427 871 286
7.00am-9.00am	Confirmation of all Senior entries, Scrutineering, distribution of Chassis and Engine Tags and Tyre Scanning – by DKC and IKD.
7.30am	Drivers' Briefing for all Senior Classes only
8.00am-1.00pm	Timed practice for Seniors only <u>*Drivers must have confirmed entry and transponders must be fitted to decide qualifying grid order</u>
1.30pm – 5.00pm	Seniors only Qualifying followed by Heat 1
5.00pm – 6.00pm	Confirmation of Junior Entries.

Saturday, 21st March 2015

6.00am	Gates Open
6.00am	Pit Allocation
7.00am-9.00am	Confirmation of all Junior entries, Scrutineering, distribution of Chassis and Engine Tags and Tyre Scanning – by DKC and IKD.
7.30am	Drivers' Briefing for all Junior Classes only
8.00am-1.00pm	Timed practice for Juniors only <u>*Drivers must have confirmed entry and transponders must be fitted to decide qualifying grid order.</u>
	Seniors Heat 2
1.00pm-5.00pm	Juniors Qualifying, Heats 1 & 2 Seniors Heat 3 Refer to Meeting Program for running order of events

Sunday, 22nd March 2015

6.00am	Gates open
8.00am	Juniors Heat 3 followed by Pre-final & Finals for all classes

Note:**Starting and Finishing Times of All Competitions**

A MEETING PROGRAM for each Class competing at the Meeting will be provided in further Supplementary Regulations to be published after the Close of Entries in accordance with the provisions of the Competition Rules, Chapter 1, Rule 3 d).

*Any Addendums to these Supplementary Regulations can be viewed on the Karting Australia website at <http://www.karting.net.au/administration/supplementary-regulations>

RACE ORDER

Due to the nature of this event, a Race Order as such cannot be defined. Please refer to the Meeting Program's Running Order for further information.

The Running Order will not be changed. The Officials of the Meeting may adjust the running order temporarily in the interest of continuing the meeting.

PRIZES: Trophies will be awarded in accordance with the provisions of Competition Rules, Chapter 5, Rule 4 r) and the Series Sporting Regulations.

GENERAL REGULATIONS**MECHANICAL BREAKDOWN LANE** (Refer General Rules, Chapter 4 Rule 11):

The Mechanical Breakdown lane will not be in use at this event.

KART RETRIEVAL:

Pit Crew with trolleys will NOT be given access to the circuit during qualifying and racing. Retrieval is at the discretion of the Clerk of the Course.

Pit Crew must only enter the Circuit when permitted by the Grid Marshall and then only if wearing "hi-viz" attire. Karts can be retrieved via access through the In/Out grid.

INSURANCE:

Has been effected for this Meeting in accordance with General Rules, Chapter 3 of the 2015 KA Manual.

SCRUTINEERING:

Scrutineering for this race meeting will be in accordance with the provisions of the Technical Rules, Chapter 6 of the KA Rules.

In accordance with the provisions of the Technical Rules, Chapter 6 of the 2015 KA Manual, each kart shall have affixed to it a correct scrutineering sticker or identifying mark supplied for the meeting. This signifies that the driver has confirmed their entry for the meeting and completed a Scrutineering Form relevant to the entry.

As from 20th March, the Grid Marshall / Scrutineers shall not permit any kart that does not display a correct scrutineering sticker or identifying mark to practice, qualify or race.

ENGINE SEALING AND CHASSIS TAGGING:

Each engine and chassis must be sealed and tagged in accordance with the provisions of Technical Rules, Chapter 6.

CONTROL FUEL:

In accordance with the provisions of the Technical Rules, Chapter 3, Control Fuel will be used for this Meeting and can only be purchased from:

- (i) Fuel Brand: Caltex.
- (ii) Fuel Type: PULP
- (iii) Supplier: Caltex Talmac Service Station.
- (iv) Competitors in all Classes must use the Control Fuel
- (v) Supply Location: Corner Bourke and Erskine Streets, Dubbo.
- (vi) Control Fuel for the Meeting can be purchased from Thursday 19th March 2015 to 22nd March 2015.
*Proof of purchase receipts must be retained and produced to the Chief Technical Officer as and when required.
- (vii) Control Fuel must be used from 8.00am Friday 20th March 2015 until the conclusion of the Meeting.

Random samples of competitor's fuel may be taken during the Meeting and tested for conformity to samples of the Control Fuel taken from the supplier on these dates. Competitors are reminded that fuel tanks and drums should be empty prior to being used for fuel purchased for this meeting. No dumping of fuel will be allowed on site.

TRANSPONDER FITTING INSTRUCTIONS:

AMB compatible transponders must be mounted in accordance with Technical Rules, Chapter 1, Rule 8 i).

Timing Transponders must be operating in accordance with the Rules including the provisions of the Series Sporting Regulations.

TIMING AND LAP SCORING RECORDING:

Will be conducted in accordance with Competition Rules, Chapter 5, Rule 4 j).

KART NUMBERS

Competitors who are registered for the Rotax Pro Tour will use their registered competition number for this meeting. Registered Rotax Pro Tour Competitors will have preference to their Competition Number.

TYRE POOLING (Technical Rules, Chapter 4, Rule 5.

Tyre Pooling will not occur at this meeting.

All competitors are required to have Barcoded Tyres for this meeting. **Race tyres must be presented for scanning before qualifying at the appropriate time. Tyre scanning will be conducted between 7.00am-9.00am on Friday 20th March and Saturday 21st March 2015.**

If the meeting is declared wet, competitors will be required to present their wet weather tyres for marking as directed by officials.

NOTICE BOARD LOCATION

Official notices will be posted on the Bulletin Board located at front wall of the Canteen Building.

VEHICLE / TRAILER ACCESS:

No Motor Vehicles will be allowed in Pit Area. Trailers and vehicle designation to be arranged through the club officer by email to – dubbokartclub@hotmail.com Attention Bert Wrigley.

SECURITY:

Security will be provided from Thursday 19th March to Sunday 22nd March 2015. Security will be onsite from 7pm each day. **The pit area will be locked each night between 8pm and 6am.**

TRADE AREAS

Limited trade areas will be made available to Traders on application to and at the discretion /approval of the Organisers. If Trade Areas are required please email dubbokartclub@hotmail.com Attention Bert Wrigley or phone/text 0427 871 286

PUBLIC RELATIONS ACTIVITY

Competitors may be required to make themselves available for interviews, photographs and public relations related activities whenever possible. A representative from the Promoter or Host Club will advise when and what is required.

SPONSOR & TRADE ACTIVITY

The Organiser/Promoter may have entered into agreements with sponsors for the event. Such sponsorship will take precedence over any other sponsorship and/or trade agreement in place by the host club and/or competitors.

If requested by the Organiser/Promoter the host club and/or competitor will remove conflicting signage and/or trade activities for the duration of the meeting.

CANTEEN:

Friday 7am to 3pm

Saturday 7am to 4pm

Sunday 7am to 4pm

FURTHER NOTES:

- No animals allowed anywhere within the facility
- No dumping of tyres or fuel, please make other arrangements
- No unlicensed driving of motor vehicles permitted at the circuit
- No motorised scooters, mini bikes, roller blading, skateboards and tricycles allowed at the complex during the entire meeting. Officials may confiscate any such items for the duration of the event.
- Marquees are not to be erected without consent of the Club
- Camping is allowed at the Complex. Please enquire to the On-site Caretaker for a camping location.

The club DOES NOT have EFTPOS facilities available trackside.

MICRO MAX AND MINI MAX SPECIFIC INFORMATION

The Competition for Rotax Micro Max and Rotax Mini Max will be conducted under the KA Junior Max Technical Rules and homologation as modified in accordance with the Supplementary Rules specific for "Micro Max" and "Mini Max" as attached to these Supplementary Regulations on the following pages.

These Supplementary Regulations must be read in conjunction with the 2015 KA Manual and all published Amendments.



Supplementary Rules specific for “Micro MAX” and “Mini MAX” to be read in conjunction with KA Technical Rules for “Junior Max”

Rotax Pro Tour - Round 2 - 2015

Micro MAX

Squish gap:

- a) 125 Micro MAX 2,40-2,70mm
- b) To achieve the defined squish gap, a spacer (ROTAX part no. 626 420, same shape as a cylinder base gasket) with a thickness of 1,25mm OR 1mm plus the different required base gaskets must be used.

The squish gap must be measured with a certified slide gauge and by using a 3 mm tin wire. The crankshaft must be turned by hand slowly over TDC (top dead center) to squeeze the tin wire.

Recommended 3mm tin wire (ROTAX part no. 580 132).

The squish gap must be measured on the left and right side in the direction of the piston pin.

The average value of the two measurements counts.

Exhaust restrictor:

- a) The exhaust restrictor (ROTAX part no. 273 972) must be used instead of the original exhaust socket (fitted to the cylinder).
- b) The exhaust restrictor must show an inner-diameter **not bigger than 22,0 +0,20 mm**.

Carburetor:

- a) The spacer (pos. 1, see illustration below, ROTAX part no. 251 730) must be fitted in the carburetor to limit the opening of the throttle.
- b) The length of the spacer has to be 38,0 +/-0,2 mm.

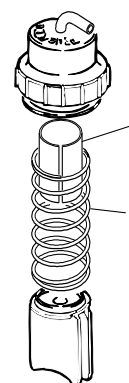

- c) The tolerance gauge (ROTAX part no. 277 400) must **not** be able to turn around (opening limit of carburetor slide)!



- d) The position of the cap of the carburetor must be fixed by means of the fixation plate (pos. 1 see illustration below, ROTAX part no. 251 790, see attached picture).
- e) The cap of the carburetor has to be screwed completely on to the carburetor.



- f) Only one rubber gasket is allowed to be used in the carburetor cap.

Radiator:

- a) A specific "Micro MAX" radiator (ROTAX part no. 295 924 or 295 923) must be used instead of the original radiator.

- b) Radiator must be mounted with all components similar to the illustration version 2 or 3 for the 125 MAX engine.

(see item 9.7.8 of the technical regulations 2014).

- c) Cooling area:

height = 280 - 300 mm

width = 58 - 62 mm

thickness of radiator = 30 - 34 mm

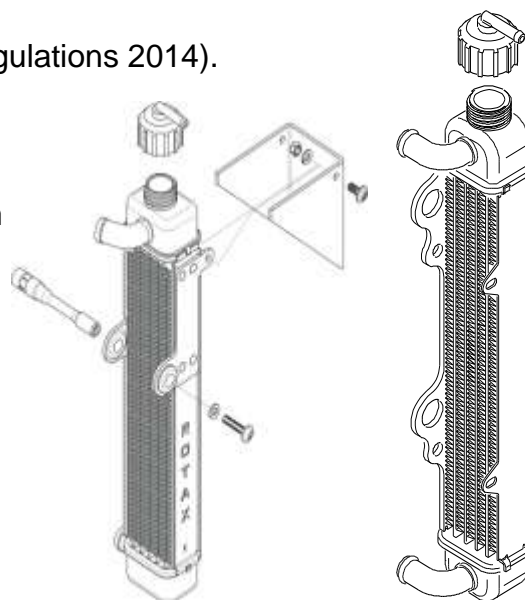

Exhaust system:

- a) The specific "Micro MAX" exhaust system must be used instead of the original exhaust system (see illustration below).
- b) The inner diameter of the 90° tube at the end of the silencer must be 15 +/- 0,30 mm.

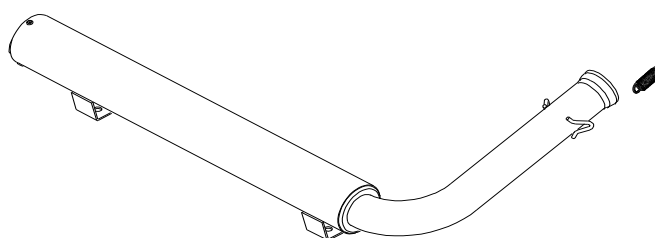

- c) No exhaust leakage allowed (no signs of oil). Exhaust must be sealed with heat resistant silicone ("XPS KartTec instant gasket black part no. 25151" or equivalent).
- d) For measuring the exhaust gas temperature, it is allowed to weld on a socket of the exhaust in an area of 50 - 80 mm from the ball joint.
- e) Usage of 4 attachment springs is mandatory (exhaust pipe to exhaust flange).
- f) No modification, damage or distortion of exhaust pipe and exhaust socket is permitted.

Cylinder:

- a) The cylinder (ROTAX part no. 223 994) must be cast with two "Letters" within a circle on the drive side, and not a number.
- b) Any combination of two "Letters" is acceptable. Photo is for illustration purposes only.



Mini MAX

Squish gap:

- a) 125 Mini MAX 1,20-1,80mm

The squish gap must be measured with a certified slide gauge and by using a 2 mm tin wire. The crankshaft must be turned by hand slowly over TDC (top dead center) to squeeze the tin wire.

Recommended 2mm tin wire (ROTAX part no. 580 130).

The squish gap must be measured on the left and right side in the direction of the piston pin.

The average value of the two measurements counts.

Intake restrictor:

- a) The intake restrictor (ROTAX part no. 267 535) must be fitted between the carburetor flange and the carburetor.

The intake restrictor must show an inner diameter of $19,0 +0,0/-0,2$ mm.

The intake restrictor must show a blue anodized surface.

Exhaust system:

- a) The exhaust restrictor (ROTAX part no. 273 972) must be used instead of the original exhaust socket (fitted to the cylinder).
- b) The exhaust restrictor must show an inner-diameter **not bigger than $22,0 + 0,20$ mm.**
- c) Exhaust steel mat is an allowed option.

Cylinder:

- a) The cylinder (ROTAX part no. 223 994) must be cast with two "Letters" within a circle on the drive side, and not a number.
- b) Any combination of two "Letters" is acceptable. Photo is for illustration purposes only.

